

**PROJECT INFORMATION**

PROJECT NAME: FERRELL COMMONS OFFICES

DATE COMPLETED: MARCH 2017

PROJECT NUMBER: MP 14007004

PROJECT MANAGER: JEREMY WILLIAMSON

SQUARE FOOTAGE: 800 GSF

COST PER SQUARE FOOT: \$90/SF

PROJECT DESCRIPTION:

OSM BLDG 7C - ADD TWO OFFICES IN CURRENT MTG. RM. &amp; TWO OFFICES IN CURRENT LOBBY AREA TO ACCOMMODATE NEW STAFFING

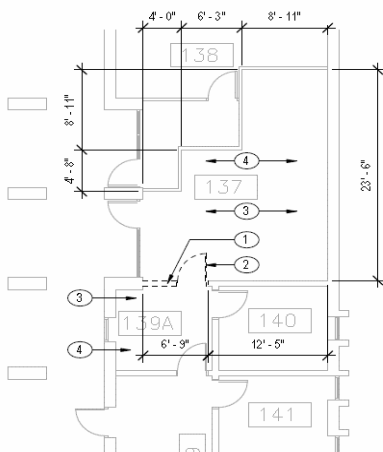
**PROJECT IMAGES**

- GENERAL NOTES:**
- REFER TO IFC'S COMMENTS FOR ADDITIONAL REQUIREMENTS.
  - CONTRACTOR TO FIELD THE FIVE MENSURE DUCKS.
  - SCHEMATIC MENSURE AT TOOKNOY CONNECTIONS.
  - EXISTING OFFICE TO BE REPLACED.
  - EXISTING PARTITION OF NEW OFFICES TO BE REPLACED.
  - FINISH CARPET TO BE RE-INSTALL AS.
  - NEW PARTITION WALLS TO BE FINISHED SOLID BLACK AND VILL BE 1 1/2" METAL SLATS WITH 1" TOP BARRIERS ONE-WAY GLASS. CALLS TO TRAINING 1" ABOVE CEILING.

- |   |  |
|---|--|
| 1 | 1 1/2" x 1 1/2" x 4" DOOR DOOR FRAME   |
| 2 | METAL LOCK SYSTEM                      |
| 3 | PROVIDE LOCK TOW OFF FIRE HOSE CABINET |

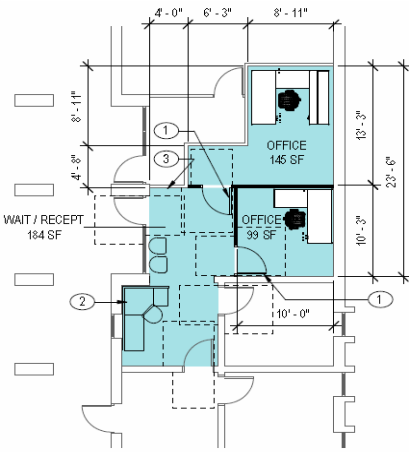

- GENERAL NOTES:**
- REFER TO IFC'S COMMENTS FOR ADDITIONAL REQUIREMENTS.
  - CONTRACTOR TO FIELD THE FIVE MENSURE DUCKS.
  - SCHEMATIC MENSURE AT TOOKNOY CONNECTIONS.
  - EXISTING OFFICE TO BE REPLACED.
  - EXISTING PARTITION OF NEW OFFICES TO BE REPLACED.
  - FINISH CARPET TO BE RE-INSTALL AS.
  - NEW PARTITION WALLS TO BE FINISHED SOLID BLACK AND VILL BE 1 1/2" METAL SLATS WITH 1" TOP BARRIERS ONE-WAY GLASS. CALLS TO TRAINING 1" ABOVE CEILING.

- |   |  |
|---|--|
| 1 | 1 1/2" x 1 1/2" x 4" DOOR DOOR FRAME   |
| 2 | METAL LOCK SYSTEM                      |
| 3 | PROVIDE LOCK TOW OFF FIRE HOSE CABINET |

PROJECT INFORMATION	
PROJECT NAME: FERRELL COMMONS OFFICES	DATE COMPLETED: MARCH 2017
PROJECT NUMBER: MP 14007004	PROJECT MANAGER: JEREMY WILLIAMSON
SQUARE FOOTAGE: 800 GSF	COST PER SQUARE FOOT: \$90/SF
PROJECT DESCRIPTION: OSM BLDG 7C - ADD TWO OFFICES IN CURRENT MTG. RM. & TWO OFFICES IN CURRENT LOBBY AREA TO ACCOMMODATE NEW STAFFING	

PROJECT COST		PROJECT TIME		
<b>DESIGN COST</b>	<b>\$ 19,600.00</b>	START	PROJECT SUBMITTED BY CLIENT	1 MONTH
ARCHITECT / ENGINEER / INTERIOR DESIGN	\$ 19,600.00		SPAA, F&S REVIEW	
<b>CONSTRUCTION COST</b>	<b>\$ 41,678.32</b>		PM ASSIGNED	
DIVISION 1 - GENERAL REQUIREMENTS (DUMPSTERS, ETC.)			PM CONTACTS REQUESTER	
DIVISION 2 - EXISTING CONDITIONS	\$ 2,100.00		PM DEVELOPS SCOPE	
DIVISION 3 - CONCRETE		RE-DESIGN	A/E SELECTED	3 MONTHS
DIVISION 4 - MASONRY			A/E PROPOSAL REVIEW	
DIVISION 5 - METALS			MPP TO CLIENT	
DIVISION 6 - WOOD, PLASTICS & COMPOSITES			CLIENT APPROVAL AND FUNDING	
DIVISION 7 - THERMAL & MOISTURE PROTECTION			REQUISITION GENERATED	
DIVISION 8 - OPENINGS	\$ 5,205.00		PO ISSUED (NOTICE TO PROCEED)	
DIVISION 9 - FINISHES	\$ 19,324.48		A/E DESIGN	
DIVISION 10 - SPECIALTIES			WORKSHOPS	
DIVISION 11 - EQUIPMENT			PERMIT REVIEWS	
DIVISION 12 - FURNISHINGS	\$ 50.00		BID/PERMIT	
DIVISION 13 - SPECIAL CONSTRUCTION		PERMIT SUBMISSION		
DIVISION 14 - CONVEYING EQUIPMENT		BUILDING CODE OFFICE REVIEW		
DIVISION 21 - FIRE SUPPRESSION		STATE FIRE MARSHALL REVIEW		
DIVISION 22 - PLUMBING		CONTRACTOR WALK-THROUGH		
DIVISION 23 - HVAC	\$ 4,537.00	CONTRACTOR BID		
DIVISION 26 - ELECTRICAL	\$ 7,320.00	PM REVIEWS BID		
DIVISION 27 - COMMUNICATIONS		AVP F&S APPROVAL OF BID		
DIVISION 28 - ELECTRONIC SAFETY & SECURITY		PM PREPARES MPP		
DIVISION 31 - EARTHWORK		MPP TO CLIENT		
DIVISION 32 - EXTERIOR IMPROVEMENT		CLIENT APPROVAL AND FUNDING		
DIVISION 33 - UTILITIES		REQUISITION GENERATED		
ALLOWANCES / ALTERNATES:		PO ISSUED (NOTICE TO PROCEED)		
GENERAL LIABILITY		CONSTRUCTION	CONSTRUCTION STARTS	3 MONTHS
GENERAL CONDITIONS (STAFFING, ETC.)			RFIS, SUBMITTALS, DOCUMENTS	
CONTRACTOR'S FEE (OVERHEAD & PROFIT)	\$ 3,141.84		PROGRESS REVIEWS	
PAYMENT & PERFORMANCE BOND (NOT REQ'D IF UNDER \$100K)	\$ -		PAYMENT APPLICATIONS, INVOICES	
<b>INFORMATION TECHNOLOGIES &amp; RESOURCES COST</b>	<b>\$ 3,010.00</b>		INSPECTIONS	
COMPUTER SERVICES & TELECOMMUNICATIONS (CS&T)	\$ 3,010.00		CERTIFICATE OF COMPLETION	
OFFICE OF INSTRUCTIONAL RESOURCES (OIR)	\$ -	CERTIFICATE OF OCCUPANCY		
<b>FACILITIES &amp; SAFETY COST</b>	<b>\$ 7,494.84</b>	CLOSE-OUT	BENEFICIAL OCCUPANCY BY CLIENT	3 MONTHS
BUILDING CODE OFFICE	\$ 1,221.00		PUNCH LIST COMPLETION	
STATE FIRE MARSHALL	\$ 300.00		FINAL INVOICES	
FP&C PROFESSIONAL MANAGEMENT SERVICES (2%)	\$ 1,281.57		OWNER'S MANUALS	
FACILITIES OPERATIONS ALLOWANCE	\$ 223.44		ASSET TURNOVER TO OPERATIONS	
CONSTRUCTION CONTINGENCY (10%, REFUNDED IF NOT USED)	\$ 4,468.83	ACCOUNTING CLOSE-OUT		
<b>TOTAL PROJECT COST</b>	<b>\$ 71,783.16</b>	<b>TOTAL PROJECT TIME - 17 MONTHS</b>		